

Newnham Murren

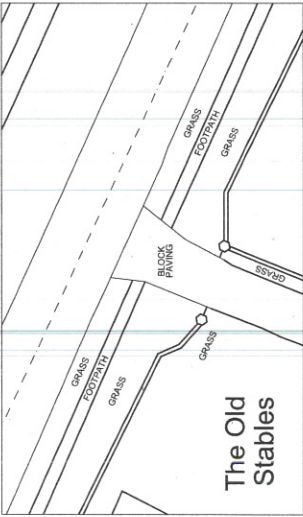

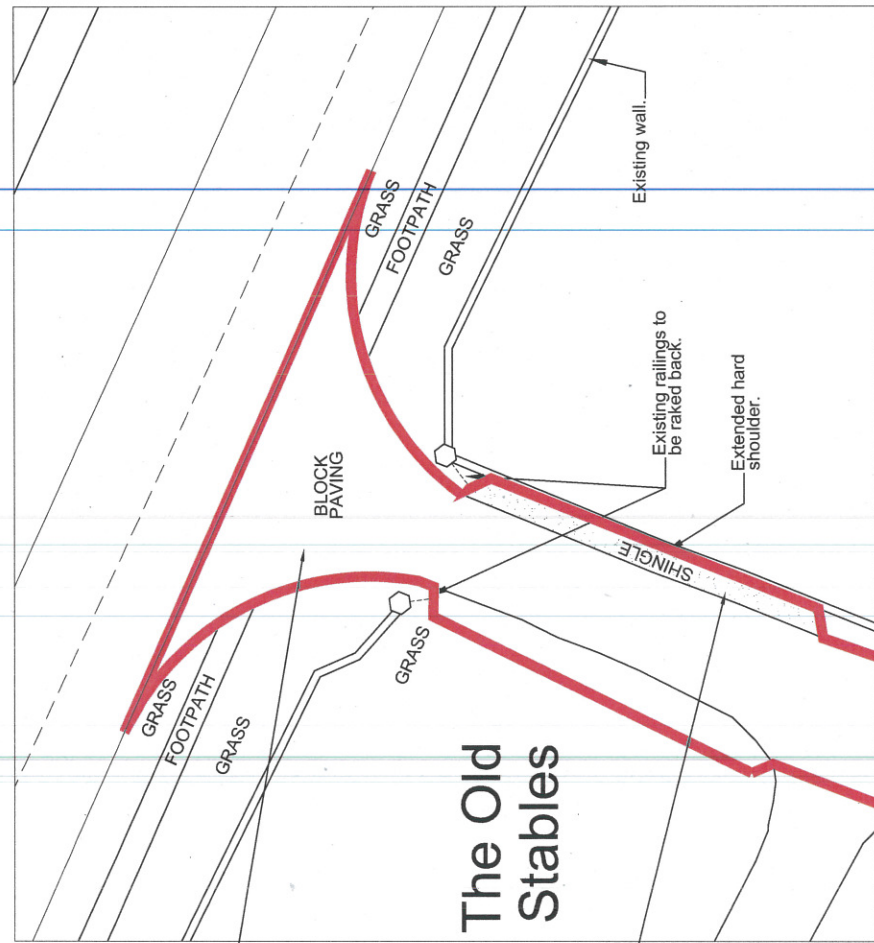

EXISTING SITE PLAN (1:200)



PROPOSED SITE PLAN (1:100)



BLOCK PAVING TO MATCH EXISTING



SHINGLE

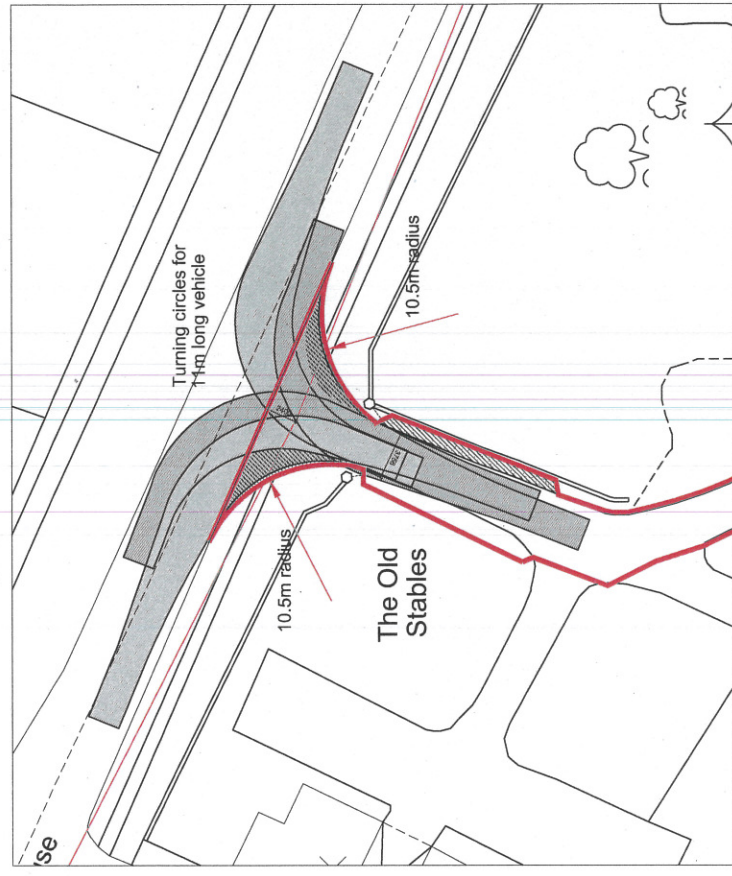

PROPOSED SITE PLAN WITH VEHICLE TRACKING (1:200)

ALL LEVELS TO MATCH EXISTING

Newnham Manor
Crowmarsh

Site Access

1:200 @ A1
05.03.12
PNC
AW

08-60-03

OXKD167264

Architecture & Building Consultancy
Wyham Court, 11 West Way, Botley, Oxford OX2 0DL
Telephone: + 044 (0)1865 269000
Facsimile: + 044 (0)1865 269001
www.savills.co.uk

